

Meeting Facilities - Full Service
Area 2 - For area locations, refer to Chicago Southland map

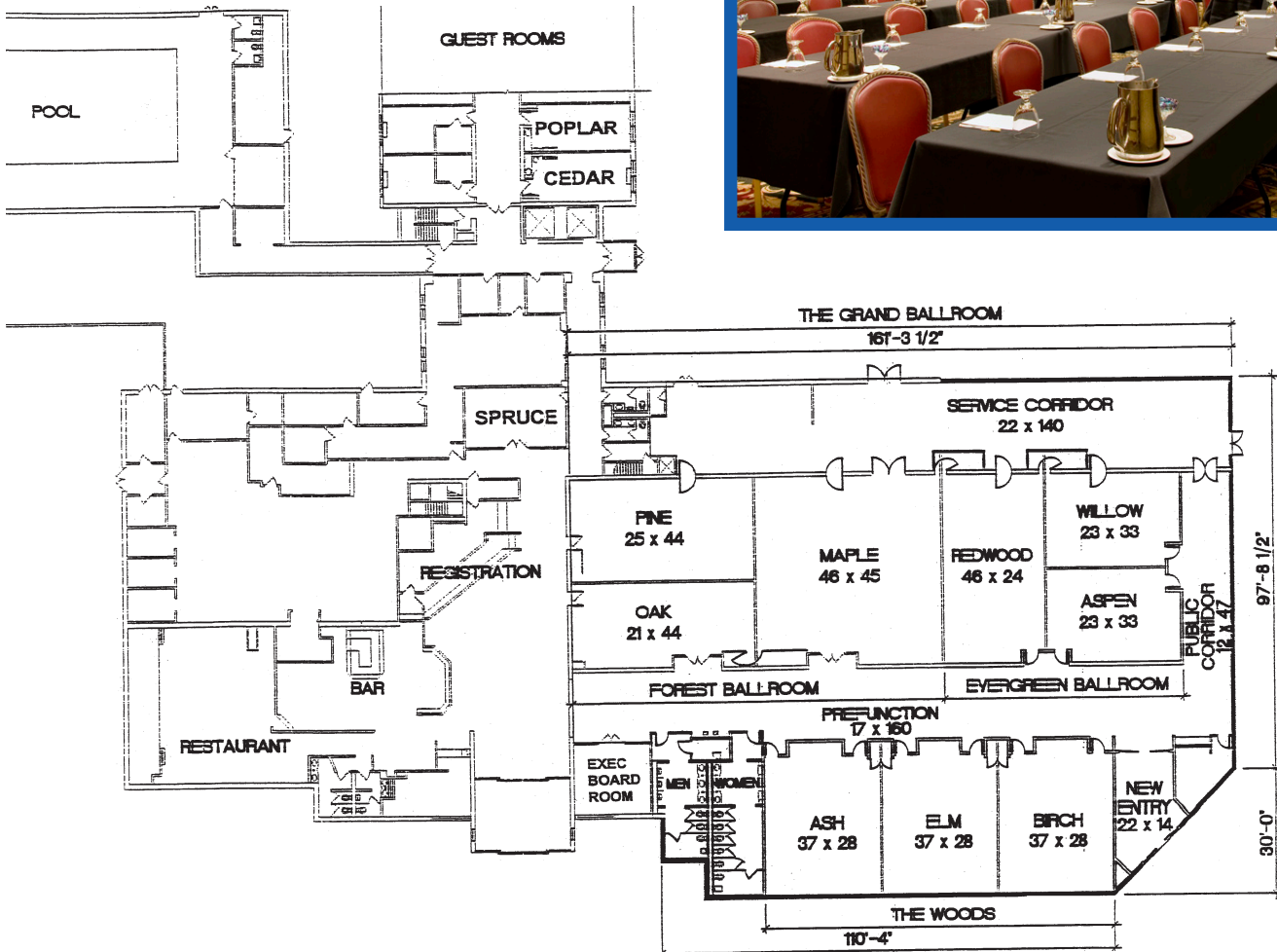

**DOUBLETREE®
HOTEL**

CHICAGO/ALSIP



ROOM	DIMENSIONS	SQ. FEET	BANQUET	CLASSROOM	THEATRE	RECEPTION	CEILING	10'x10'	8'x10'
Grand Ballroom	146'x46'	6,716	600	400	800	600	12'	44	44
Forest Ballroom	89'x46'	4,094	320	225	400	320	12'	28	28
Pine Room	44'x25'	1,100	60	32	50	60	12'	n/a	n/a
Oak Room	44'x21'	924	60	40	60	60	12'	n/a	n/a
Maple Room	45'x46'	2,070	150	125	180	150	12'	n/a	n/a
Evergreen Ballroom	57'x46'	2,622	180	170	300	180	12'	16	16
Willow Room	33'x24'	792	50	40	50	50	12'	n/a	n/a
Aspen Room	33'x22'	726	40	36	50	40	12'	n/a	n/a
Redwood	24'x46'	1,104	80	48	70	80	10'	n/a	n/a
The Woods Ballroom	84'x34'	2,856	240	144	260	215	10'	12	12
Ash Room	28'x34'	952	64	40	50	64	10'	n/a	n/a
Elm Room	28'x34'	952	64	40	50	64	10'	n/a	n/a
Birch Room	28'x34'	952	64	40	50	64	10'	n/a	n/a
Spruce Room	24'x14'	336	24	12	30	24	10'	n/a	n/a
Poplar Room	25'x12'	300	16	12	30	16	10'	n/a	n/a
Cedar Room	25'x12'	300	16	12	30	16	10'	n/a	n/a
Executive Boardroom	18'x14'	252	n/a	n/a	12	n/a	10'	n/a	n/a